



OAKLEY ESTATES

CONVENIENT TO NASHVILLE

- ***\$295 Down***
- ***Owner Financing***
- ***No Closing Costs***
- ***Low Monthly Payments***
- ***No Pre-Payment Penalties***
- ***Protective Covenants***
- ***Warranty Deed***
- ***Immediate Possession***

HURDLE.COM

(770) 554-5263 | 1-800-762-4851

P.O. Box 9 Loganville, GA 30052

OAKLEY ESTATES, COFFEE COUNTY, TN

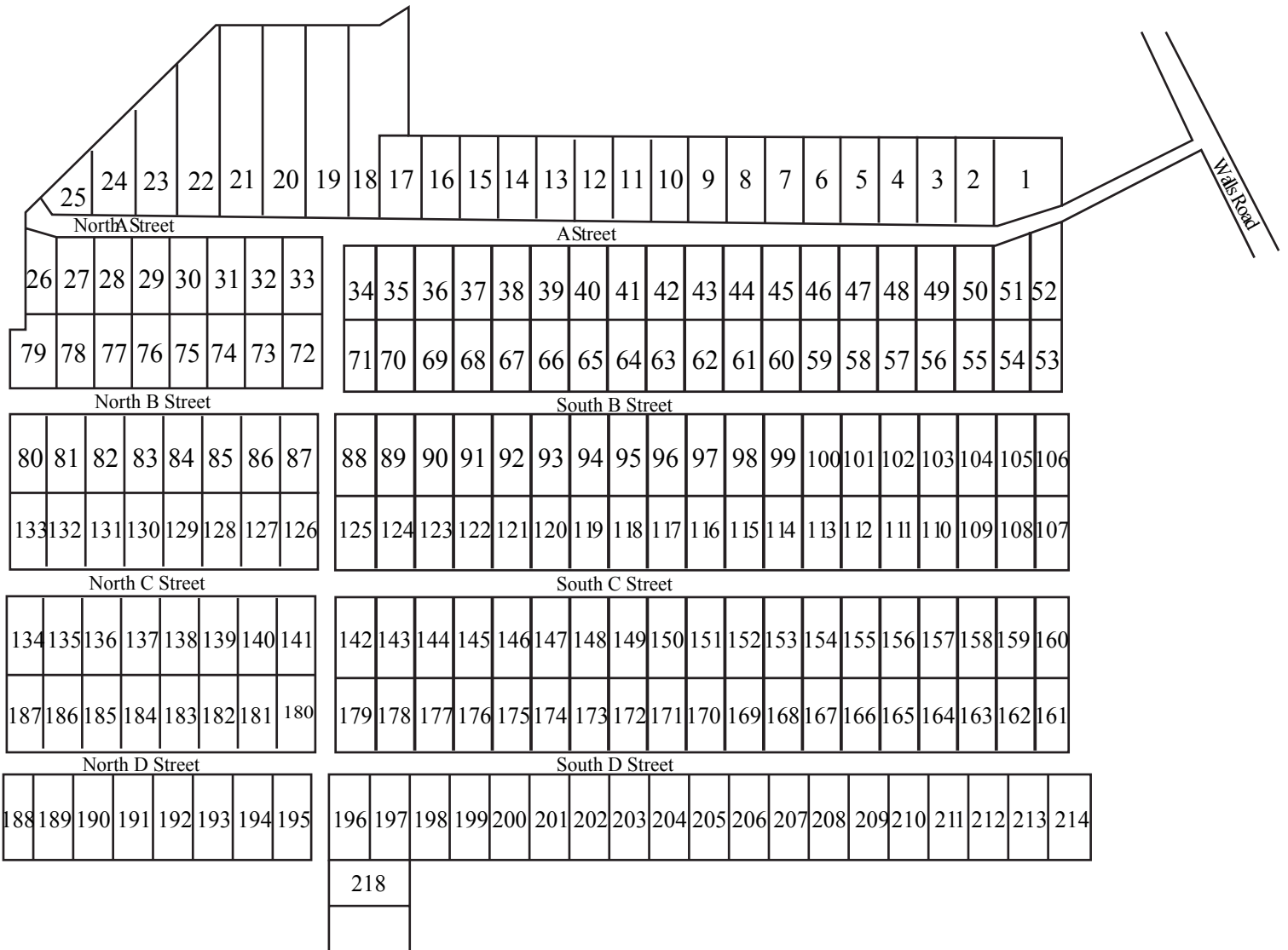

Financing Example

Purchase Price: \$29,995
Down Payment: \$295
Financed Amount: \$29,700
Interest Rate: 7.9% Fixed simple interest
Term: 360 Months
Monthly Payment: \$215.86

NO PRE-PAYMENT PENALTY
 You may pay all or part of what you owe above
 your regularly scheduled payment and 100%
 of that overage will go towards the reduction of
 your principal balance.

(770) 554-5263 | 1-800-762-4851



Directions:

- **East on Interstate 24 thru Murfreesboro & on to Manchester.**
- **Take Exit #114 in Manchester (Hwy. 41/Manchester exit)**
- **Turn left at end of exit ramp & go 5.7 miles on Hwy 41 to the junction of Hwy. 127 and Hwy. 41 in the community of Hillsboro. Turn right on Hwy. 127 & go 2.0 miles. You will cross over Interstate 24.**
- **Turn right on Newt Vanattia Road immediately after going over Interstate.**
- **Go 1/2 mile & take the first road to the right. ("A Street")**
- **Go 4/10ths of a mile & turn left on West 1st Street.**
- **Go 1 block & take a left on B Street.**
- **Land begins 200 feet up on the left.**
- **Look for signs!**

www.hurdle.com

(770) 554-5263 | 1-800-762-4851





(770) 554-5263 | 1-800-762-4851

P.O. Box 9 Loganville, GA 30052

HURDLE.COM

landinfo@hurdle.com